

**'CHUNKY'
COMMERCIAL
FILLER CAPS
(& NECKS)**

This model has been used by every British truck manufacturer as well as for 'static' applications such as power generator sets. Recommended specification is fully sealed but the 'Waso' venting system will suit some applications. Caps fit "internally-flanged" neck-ends, (illustrated) which can be brazed onto a plain filler pipe, generally at 76 mm (3-inch) diameter.



Non-locking cap with optional chain



Optional 'Snap-in' Barrel 'FS' or 'FT'

'Customised' Key option



Locking cap with optional 'Diesel' labels

ORDERING CODE

'Non-vented' models with 68 mm bayonet

- 602935** 'Chunky' cap locking, black
- 602936** 'Chunky' cap, non-locking, black
- 602888** 'Chunky' cap, locking, grey
- 604122** 'Chunky' cap, non-locking, grey

'Vented' models with 68 mm bayonet

- 600281** 'Chunky' cap, locking, black
- 600296** 'Chunky' cap, non-locking, black

616900 Steel neck-end, 77 mm diameter

616901 Steel neck-end, 58 mm diameter

(Ask for advice on suitability of caps where venting is required. EC regulations may apply).

SPECIFICATION

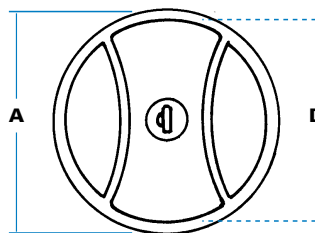
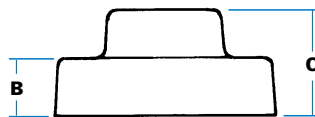

A Diameter	87 mm
B Base height	24 mm
C Max. height	42 mm
D Inside diameter	84 mm
E 'Bayonet' diameter (not shown)	68 mm

Note: Alternative 'bayonets' can be fitted at 45 mm & 55 mm diameter, but these will reduce resistance of cap to vandal attack.

Filler neck ends

These are internally-flanged neck ends in mild steel, suitable for brazing to plain pipes at 76 mm (3 inch) and 57 mm (2.25 inch) diameter. Height is 18-20 mm only.



616900
78mm I.D.
(accepts
68 mm
bayonet).

616901
58mm I.D.
(accepts
45 mm
bayonet).

! Attractive, moulded 'shroud' with textured finish, and shaped top for good grip. 'Snap-in' lock barrel allows cap to be matched with full vehicle lockset.

W Rotate cap on filler neck until fully engaged. On locking models, turn key to operate latching tongue. Key only withdraws in 'locked' position.

K 'S'-type key as standard, with shuttered keyway. Optionally 'FS', 'FT', 'DLP' or 'Ronis' key types.

P Textured finish in black or grey. Other colours to special order only.

M Zinc alloy diecastings, with mineral-filled polypropylene shroud, steel 'bayonet' & latch, and bonded steel/nitrile rubber seal.

? - Valved/vented specification
- 'Bayonets' at 45 & 55 mm
- Optional retaining chain
- 'Diesel' labels
- 'Snap-in' barrel
- 'Customised' key types.

T Caps are 100% tested to withstand tank pressure of 0.14 KgF/cm² (2 lb/in²) Inversion tests ensure caps do not exceed permitted flow rates on valved/vented models.